



Welcome to Baylor Fort Worth

Baylor All Saints Medical Center at Fort Worth, located near downtown Fort Worth, is a full-service hospital dedicated to providing high quality health care to community. Baylor Fort Worth is a not-for-profit hospital and celebrated 100 years of service in 2006. The medical center has 525 licensed beds and offers a broad range of medical services, including programs of excellence in cardiology, transplantation, neurosciences, oncology and women's services.

For access to comprehensive information about Baylor Fort Worth, including medical specialties, visit our website at BaylorHealth.com/AllSaints.

To find a physician on the medical staff at Baylor Fort Worth, please call 1.800.4BAYLOR or visit BaylorHealth.com/AllSaints.

BAYLOR
All Saints Medical Center
at Fort Worth

1400 Eighth Ave.
Fort Worth, Texas 76104
1.800.4BAYLOR
BaylorHealth.com/AllSaints

Medical Specialties

- Allergy
- Arthritis care
- Behavioral health services (outpatient; chemical and mental)
- Breast care/breast navigator
- Cardiac and pulmonary rehabilitation
- Cardiac and vascular angioplasty and stenting
- Cardiac catheterization
- Cardiac electrophysiology
- Cardiac Intensive Care Unit
- Cardiovascular Recovery Unit
- Cardiac Replacement Evaluation Program
- Cardiovascular surgery
- Chemical Dependency Unit
- Deep brain stimulation
- Dermatology
- Diabetes Management Program
- Diagnostic laboratory
- Electrodiagnostic services
- Emergency medicine
- Endocrinology
- Endoscopy
- ENT (ears, nose, and throat)
- Gastroenterology
- General and specialty surgery
- Gynecology
- Gynecologic oncology
- Headache Center
- Heart Failure Program
- Imaging services
- Infectious disease
- Inpatient dialysis
- Intensive Care Unit
- Internal medicine
- Interventional radiology
- Lymphedema Treatment Center
- Neonatal Intensive Care Unit (Level III)
- Nephrology
- Neurology and neurosurgical services
- Non-invasive cardiac diagnostic services
- Obstetrics and gynecology
- Oncology
- Oral, dental and maxillofacial surgery
- Orthopedics
- Outpatient services
- Pain management
- Pathology
- Physical medicine and rehabilitation
- Plastic surgery
- Podiatry
- Pulmonary medicine
- Radiology
- Rheumatology
- Scoliosis
- Surgical oncology
- Telemetry
- Thoracic surgery
- Transplantation (liver, kidney, pancreas, islet cell)
- Urogynecology
- Urology surgery
- Vascular surgery
- Weight loss surgery
- Wellness
- Women's services
- Wound Care Center

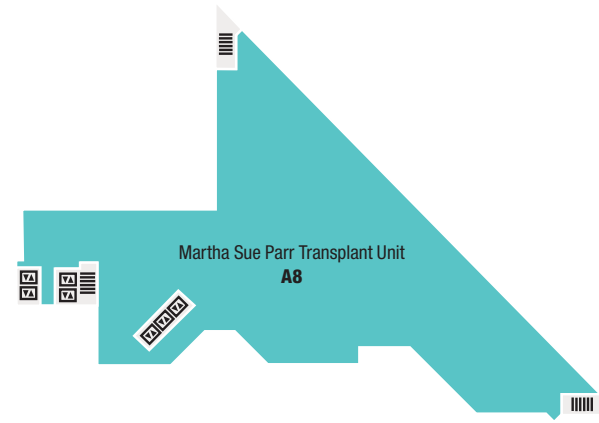

Eighth Floor

Since December 1984, Baylor's Annette C. and Harold C. Simmons Transplant Institute, an integration of transplant services of Baylor Fort Worth and Baylor University Medical Center at Dallas, has become one of the nation's top transplant programs. The Martha Sue Parr Transplant Unit, located on the eighth floor of the Martin Tower, features specially trained medical professionals dedicated to serving the needs of our transplant patients.

- LEGEND**
- BUILDING A—MARTIN TOWER
 - BUILDING B—MONCRIEF TOWER
 - BUILDING C—TC TERRELL MD TOWER
 - BUILDING D—MACC BUILDING
 - PAUL AND JUDY ANDREWS WOMEN'S HOSPITAL
 - CARTER REHABILITATION AND FITNESS CENTER
 - MISCELLANEOUS
 - ELEVATORS
 - STAIRS
 - REST ROOMS

Physicians are members of the medical staff at one of Baylor Health Care System's subsidiary, community or affiliated medical centers and are neither employees nor agents of those medical centers, Baylor All Saints Medical Center at Fort Worth or Baylor Health Care System. ©2011 Baylor Health Care System. DH_BASMCFW_1004_2012.

Finding Your Way

Around Baylor All Saints Medical Center at Fort Worth



BAYLOR
All Saints Medical Center
at Fort Worth

- LEGEND**
- BUILDING A—MARTIN TOWER
 - BUILDING B—MONCRIEF TOWER
 - BUILDING C—TC TERRELL MD TOWER
 - BUILDING D—MACC BUILDING
 - PAUL AND JUDY ANDREWS WOMEN'S HOSPITAL
 - CARTER REHABILITATION AND FITNESS CENTER
 - MISCELLANEOUS
 - ELEVATORS
 - STAIRS
 - REST ROOMS



Baylor Fort Worth is located south of downtown Fort Worth in the hospital district and is accessible via the Fort Worth freeway system.

Area Map

Vallet parking is available at the main entrance off Magnolia Avenue (★) and between the Professional Pavilion and Pavilion garage. The fee for vallet parking is \$5. Patient drop-off and pickup are located at both vallet areas. Covered self-parking is located off Enderly Place (★).

Campus Map



Our Emergency Department (ED) is easily accessible on the ground floor of the Martin Tower. The ED is staffed by more than 50 registered nurses and 19 technicians who, along with physicians on our medical staff, specialize in emergency and trauma care. This floor also features the West Auditorium, the site of many seminars and meetings, as well as support and administrative services.

Ground Floor

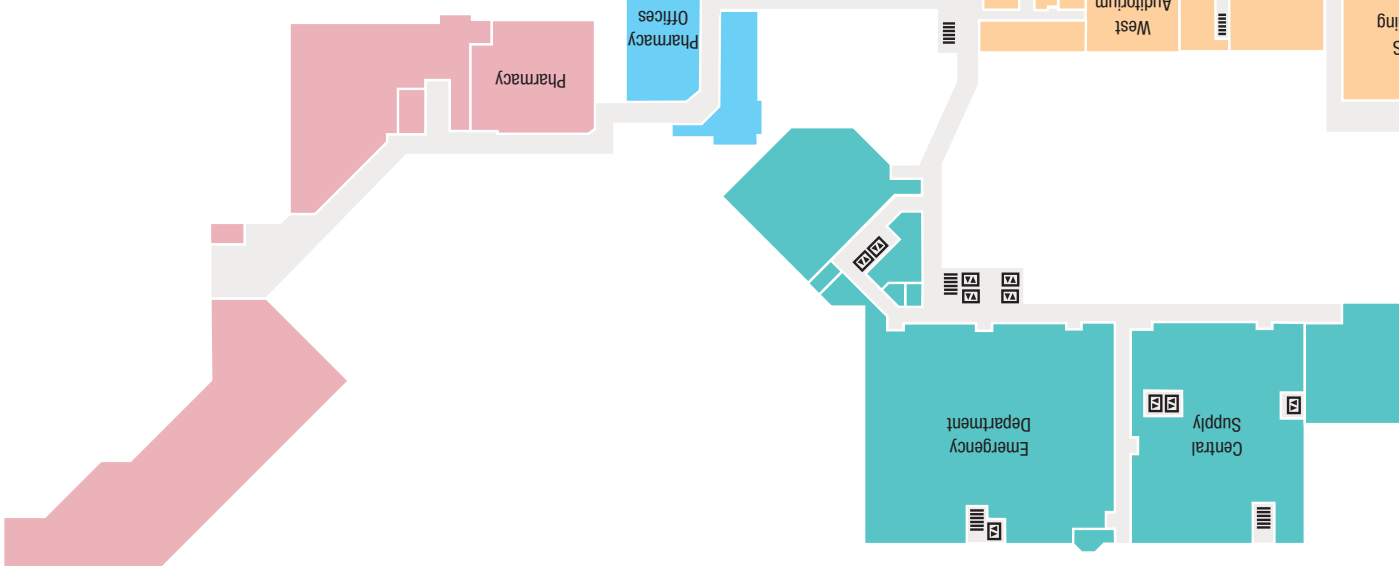



First Floor

The first floor features our Labor and Delivery Department in Baylor Fort Worth's Andrews Women's Hospital, the Joan Katz Breast Center at Baylor Fort Worth in the Martin Tower and the Frances and Frank Turella Lymphedema Center in the Moncrief Tower. It also offers the endocrinology center, day surgery and transplant clinic in the Martin Tower. Guests can also enjoy a delicious meal in the 1400 Café and calming views of the beautiful Atrium Garden on the first floor of the Martin Tower.

- LEGEND**
- BUILDING A—MARTIN TOWER
 - BUILDING B—MONCRIEF TOWER
 - BUILDING C—TC TERRELL MD TOWER
 - BUILDING D—MACC BUILDING
 - PAUL AND JUDY ANDREWS WOMEN'S HOSPITAL
 - CARTER REHABILITATION AND FITNESS CENTER
 - MISCELLANEOUS
 - E ELEVATORS
 - STAIRS
 - R REST ROOMS

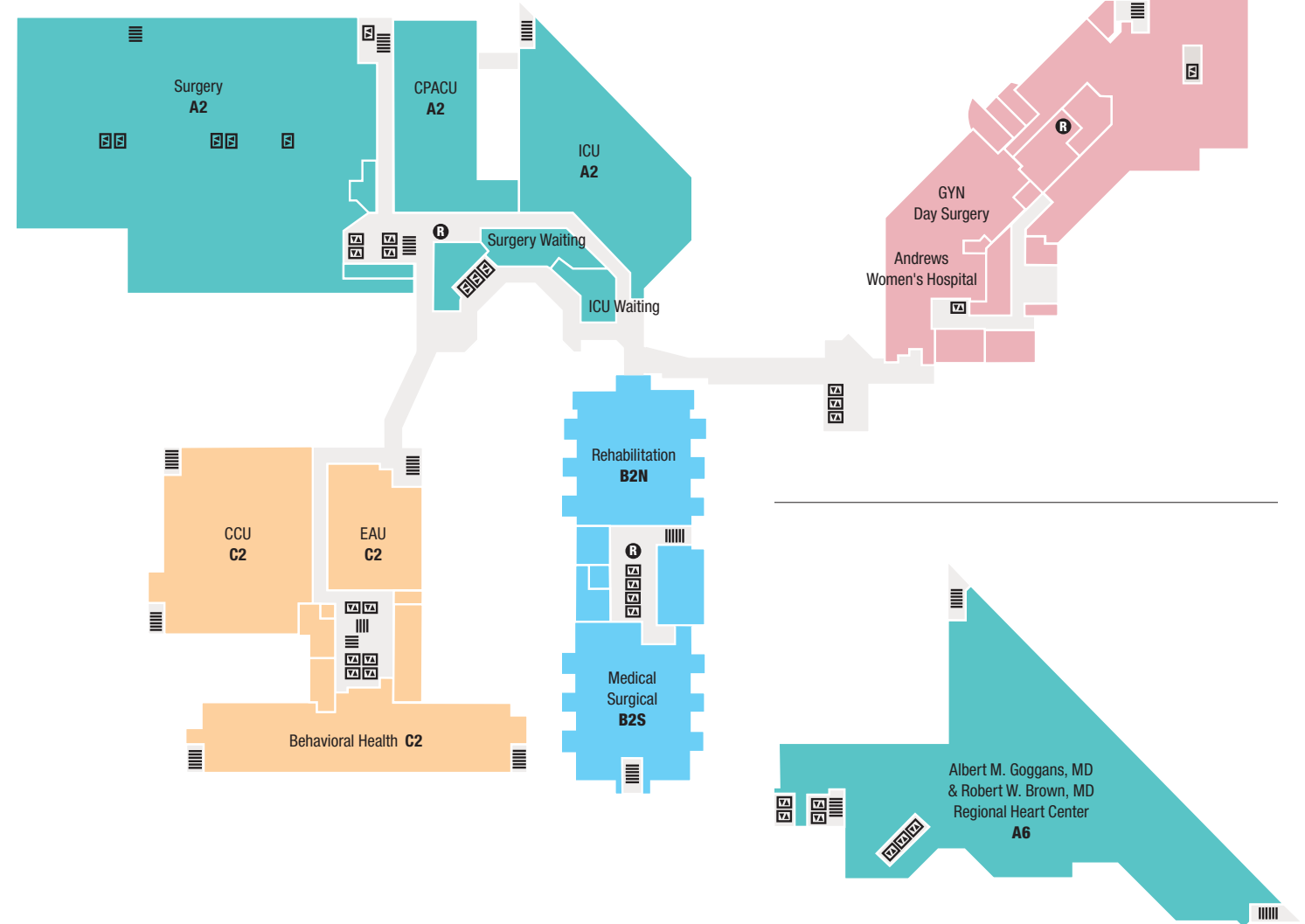
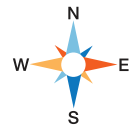

Second Floor

The second floor provides convenient access to our gynecological inpatient and day surgery services in Baylor All Saints Medical Center's Andrews Women's Hospital. The second floor of the TC Terrell MD Tower features the Coronary Care Unit (CCU), cardiovascular rehabilitation and behavioral health services; the Martin Tower offers surgery and surgery waiting area, Intensive Care Unit (ICU) and the Post Anesthesia Care Unit (CPACU). Rehabilitation services and medical-surgical patients are located on the second floor of the Moncrief Tower.

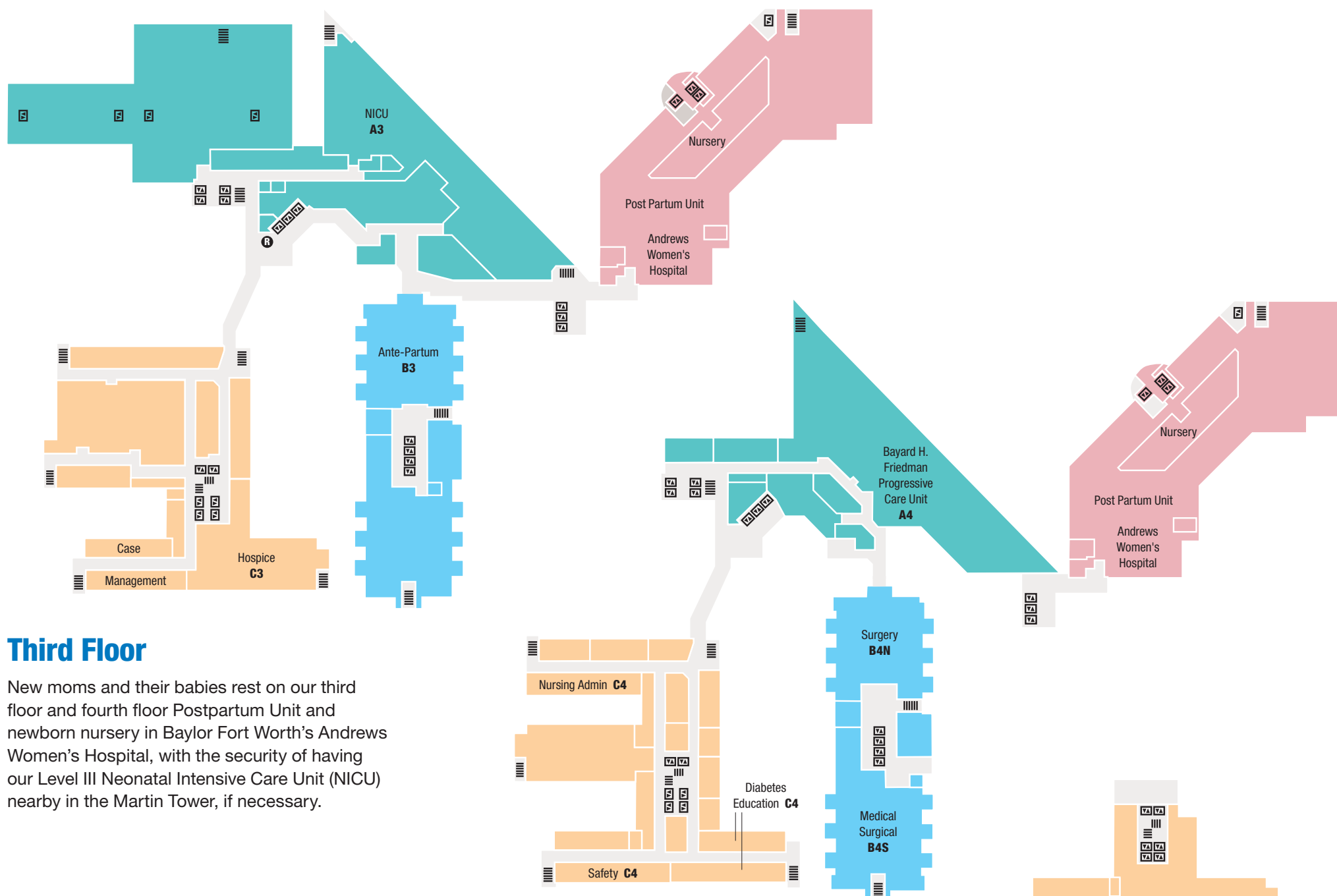

Third Floor

New moms and their babies rest on our third floor and fourth floor Postpartum Unit and newborn nursery in Baylor Fort Worth's Andrews Women's Hospital, with the security of having our Level III Neonatal Intensive Care Unit (NICU) nearby in the Martin Tower, if necessary.

- LEGEND**
- BUILDING A—MARTIN TOWER
 - BUILDING B—MONCRIEF TOWER
 - BUILDING C—TC TERRELL MD TOWER
 - BUILDING D—MACC BUILDING
 - PAUL AND JUDY ANDREWS WOMEN'S HOSPITAL
 - CARTER REHABILITATION AND FITNESS CENTER
 - MISCELLANEOUS
 - E ELEVATORS
 - STAIRS
 - R REST ROOMS



Fourth Floor

The beautiful Postpartum Unit and newborn nursery also extend to our fourth floor. Surgical and medical-surgical patients are cared for on our fourth floor, as well as cardiology patients who no longer require the Intensive Care Unit (ICU) after treatment. For these patients, we offer the Bayard H. Friedman Progressive Care Unit to treat their special needs as they continue to recover.

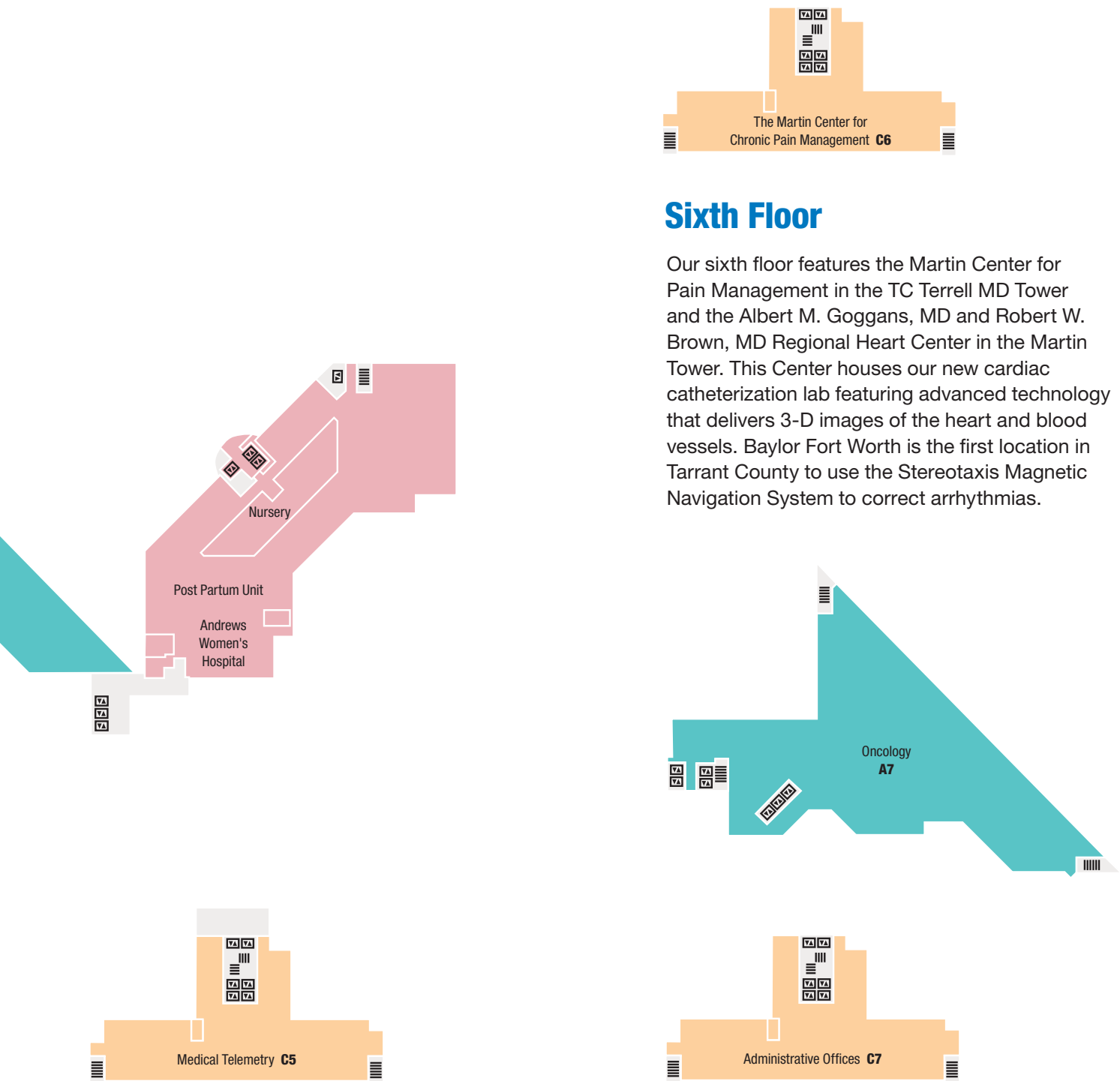

Fifth Floor

Our fifth floor in the TC Terrell MD Tower is dedicated to medical telemetry patients who are recovering from certain procedures and need care from specially trained providers.

Sixth Floor

Our sixth floor features the Martin Center for Pain Management in the TC Terrell MD Tower and the Albert M. Goggans, MD and Robert W. Brown, MD Regional Heart Center in the Martin Tower. This Center houses our new cardiac catheterization lab featuring advanced technology that delivers 3-D images of the heart and blood vessels. Baylor Fort Worth is the first location in Tarrant County to use the Stereotaxis Magnetic Navigation System to correct arrhythmias.

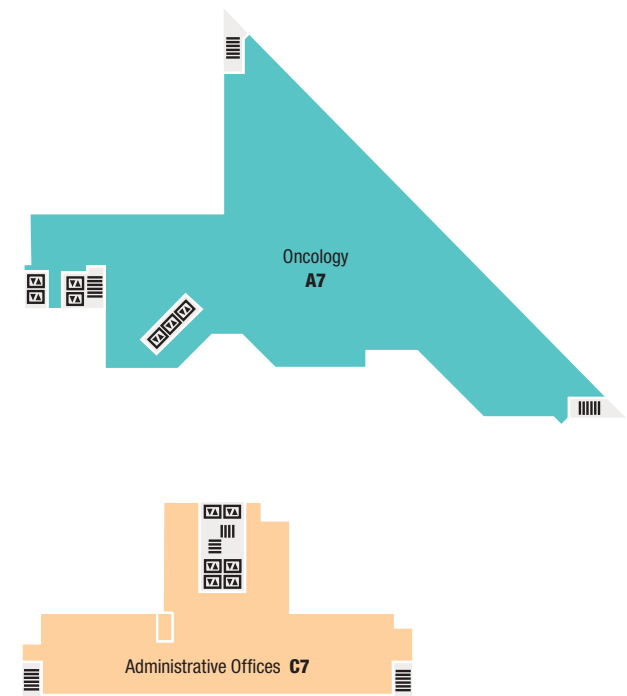

Seventh Floor

We have dedicated the seventh floor in the Martin Tower to our oncology inpatient services. We offer a comprehensive cancer program that goes beyond just treating the disease with advanced therapies, but also includes psychosocial, emotional and spiritual support.